

2243 Orchid Loop, St Cloud, MN 56301

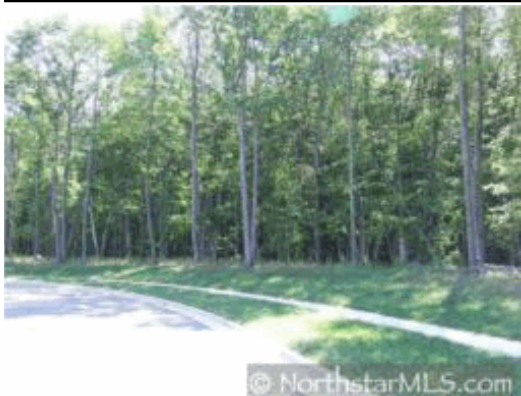

Status: **Active**

List Price: **\$39,000**

Original List Price: **\$39,000**

Map Page: **999** Map Coord: **A1**

Directions: **Hwy 23 to Cooper to 33rd Street (R) to 21st Avenue (L) to Orchid Loop.**

MLS Area: **407 - South St. Cloud**

TAX INFORMATION

Front Dimensions: 121	Acre(s): 0.00	Property ID: 82507440607	Tax w/assess: 4,808.00
Left Dimensions: 119	Min Lot Size:	Tax Year: 2009	Assess Pend: Yes
Right Dimensions: 105	Fire #:	Tax Amt: 528.00	Homestead: No
Rear Dimensions: 69		Assess Bal: 4,281.00	Plat Recorded: Yes
List Date: 8/16/09	Received By MLS: 8/19/09	Days On Market: 87	

Development (this listing covers multiple lots)

Total Lots Available: 10	Minimum Price: \$39,000	Maximum Price: \$39,000.00
	Minimum Acres: 0	Maximum Acres: 0

General Property Information

Legal Description: Lot 3 Block 2 Sommersby	Complex/Dev/Sub:	
County: STER - Stearns		
School District: 742 - St. Cloud, 320-253-9333		
Builder Restriction: Open		
Restrictions/Covts: Unspecified		
Land Inclusions: For Sale Sign, Platted	Improvements: Curbs, Paved Streets	
Zoning: Residential-Single	Road Frontage: City, Paved Streets	
Lot Description: Tree Coverage - Light		
Available Utilities: Electric, Natural Gas	On Site Utilities: Electric	
Dev Status: Subdivided	Fencing:	
Farm Type:	Tillable Acres:	Topography: Level
Soil Type:	Pasture Acres:	Out Buildings:
Crop Type:	Wooded Acres:	Agric. Water:

Agent Remarks: **Agents verify all information. Lot is corporate-owned. Seller has no knowledge of property. Please consult proper city/county departments for building information. Jennifer Edling is also a listing agent 763-350-3175.**

Public Remarks: **Nice lot in nice neighborhood. Other lots available. Build or invest today.**

Financial

Cooperating Broker Compensation

Buyer Broker Comp: 2.7000 %	Sub-Agent Comp: 0 %	Facilitator Comp: 2.7000 %
Variable Rate: N	List Type: Exclusive Right To Sell	

In Foreclosure?: **No**
 Lender Owned?: **Yes**
 Potential Short Sale?: **No**
 Owner is an Agent?: **No**
 Sellers Terms: **Cash, Conventional**
 Existing Fin:

Listing Agent: **Sara M. Weber 612-298-3608**

Listing Office: **Edina Realty, Inc.**

Appt Phone: **763-271-5410**

Office Phone: **763-295-3456**

Co-List Agent: **Aaron M. Dickinson 612-251-5599**

This Report Prepared By: **Aaron Dickinson 612-251-5599**

2243 Orchid Loop , St Cloud, MN 56301
MLS Number: 3825746



STER - Stearns County Full Tax DisplayPID#: **82507440607**Plat Property Type: **Residential**Tax Year: **2009****Property Information for 2243 Orchid Loop S, St. Cloud, MN 56301-5867**

Subdivision (Addn): **SOMMERSBY** Lot/Block: **003/002**
 Postal City: Parcel Size:
 School District: **742 - St. Cloud** Acres:
 County Prop Type: **206** Year Built:
 Homestead Code: **Non Homestead**
 Legal Description: **Sect-34 Twp-124 Range-028 Sommersby Lot-003 Block-002**

Owner/Taxpayer Information

Owner Name, Address: **Rkp Investments Inc, 1015 W St Germain St # 440, St. Cloud, MN,**
 Taxpayer Name, Address: **Rkp Investments Inc, 1609 6th Ave N, Sartell, MN, 56377**

Market Values/Taxes/Subrecord

Market Values		Taxes		Subrecord Status	
Land:	\$35,600	Base Tax:	\$527.51	Watershed:	
Building:	\$	Assessment Amount:	\$4,280.49	Delinquent Status:	
Total:	\$35,600	Tax w/Assessment:	\$4,808.00	Green Acres/G.A. SqFt:	0/0.00

[Click Here to check for Tax and Valuation History](#)**Sales Information****Most Recent Sale:**

Sale Date: Sale Price: Sale Code:

[Click Here to check for possible additional Sale History](#)

Property Maps from REsearch MN: [Click Here to open PLAT Map](#) [Click Here to open GIS Map](#)

Detailed Dwelling Characteristics

Gross Bldg SqFt:	Building Style:	Total Beds/Baths:	/
Livable SqFt:	Number of Stories:	Family/Living Rm:	/
First Floor SqFt:	Building Shape:	Dining/Other Rm:	/
Second Floor SqFt:	Building Condition:	Kitchen:	
Basement SqFt:	Building Construction:	Fireplaces:	
Garage SqFt:	Garage Type/Capacity:	Heat:	
Deck/Patio SqFt:	Roof Type/Cover:	Air:	
Porch SqFt:	Exterior Walls:	Total Rooms:	
Pool (Y/N)/SqFt:	Interior Walls:	Lot Zoning:	
Foundation Size:	Lot Size:		

Room Schedule

Room	Bsmt	Level			Room	Bsmt	Level			Room	Bsmt	Level		
		1	2	3			1	2	3			1	2	3
Bedrooms:					Baths Full:					Kitchen:				
Family Rm:					Baths 3/4:					Fireplace:				
Living Room:					Baths 1/2:					Other Room:				

Information is Believed to be Reliable But Not Guaranteed